



*Commercial Service Parts*

**SEALED BURNER (HSP)**

Hestan Commercial Corporation  
3375 E. La Palma Ave.  
Anaheim, CA 92806  
(888) 905-7463

RETAIN THIS FOR FUTURE REFERENCE

Revised: May 15, 2020

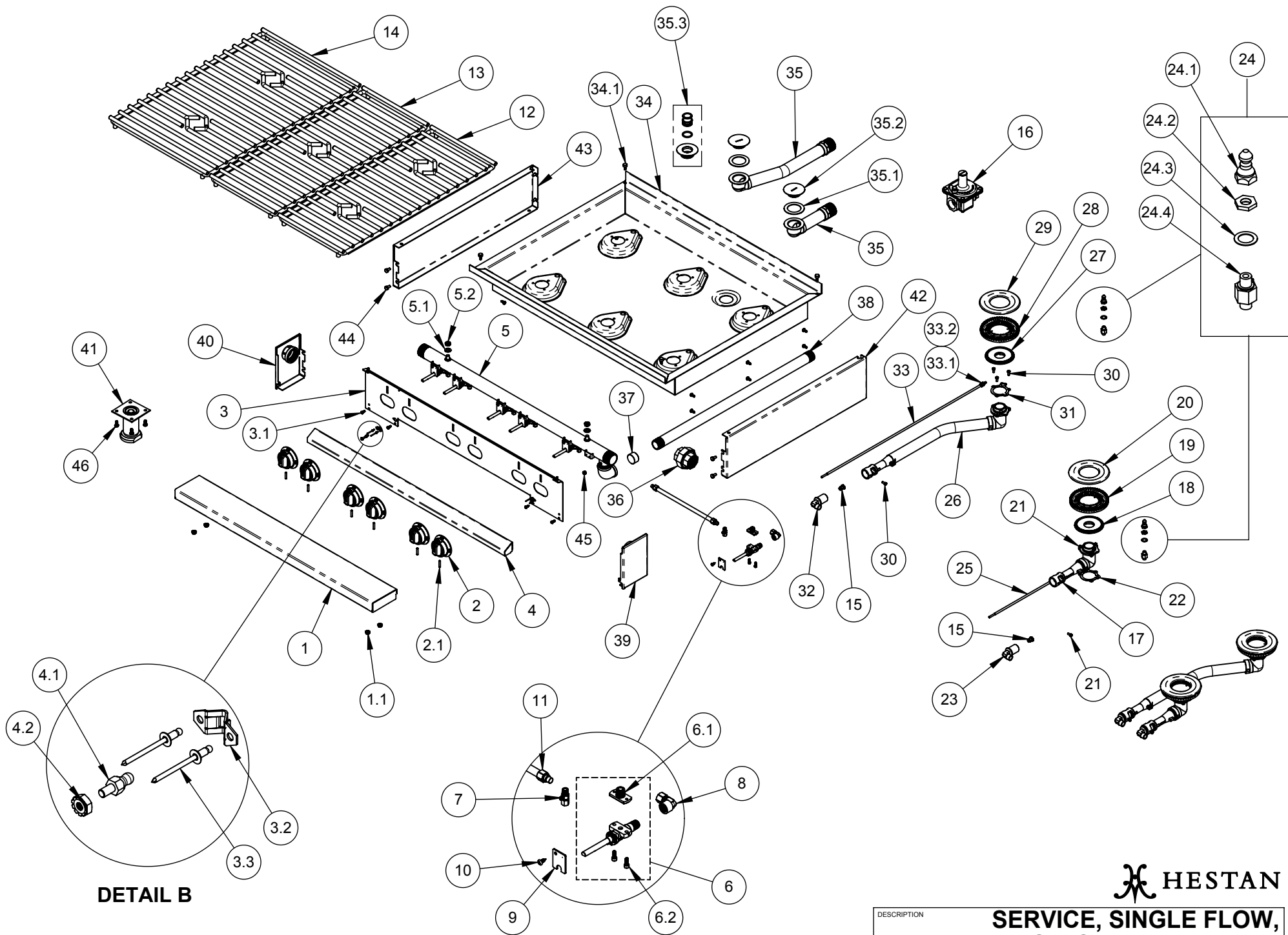

**DETAIL B**

**DETAIL A**

**HESTAN**

**SERVICE, SINGLE FLOW,  
PILOT, SEALED BURNER**

DESCRIPTION

DRAWING NO

**HSPXXX-SERVICE**

## SEALED BURNER: SINGLE FLOW, PILOT - SERVICE PARTS LIST

Item No.	Part No.	DESCRIPTION	HSP122	HSP182	HSP244	HSP364	HSP365	HSP366
			QTY	QTY	QTY	QTY	QTY	QTY
1	003659	PLATE SHELF, 12, W/A	1	-	-	-	-	-
	003660	PLATE SHELF, 18, W/A	-	1	-	-	-	-
	003662	PLATE SHELF, 24, W/A	-	-	1	-	-	-
	003664	PLATE SHELF, 36, W/A	-	-	-	1	1	1
	018046	PLATE SHELF, 6" EXTENDED, WA, 12	1	-	-	-	-	-
	034423	PLATE SHELF, 6" EXTENDED, WA, 18	-	1	-	-	-	-
	034424	PLATE SHELF, 6" EXTENDED, WA, 24	-	-	1	-	-	-
	006053	PLATE SHELF, 6" EXTENDED, WA, 36	-	-	-	1	1	1
	034428	PLATE SHELF, 8" EXTENDED, WA, 12	1	-	-	-	-	-
	034427	PLATE SHELF, 8" EXTENDED, WA, 18	-	1	-	-	-	-
	034426	PLATE SHELF, 8" EXTENDED, WA, 24	-	-	1	-	-	-
	006069	PLATE SHELF, 8" EXTENDED, WA, 36	-	-	-	1	1	1
1.1	012685	SERVICE, NUT, LOCK, SERRATED FLANGE, 1/4-20, PKG 4	1	1	1	1	1	1
2	000130	KNOB ASSY., ON-OFF,, 100%	2	2	4	4	5	6
2.1	014299	SERVICE, SETSCREW, #10-24 X 1.000, CUP PT., SS, PKG 6	1	1	1	1	1	1
3	011209	PANEL, CONTROL, SP, 122 - INDICATOR	1	-	-	-	-	-
	011204	PANEL, CONTROL, SP, 182 - INDICATOR	-	1	-	-	-	-
	011201	PANEL, CONTROL, SP, 244 - INDICATOR	-	-	1	-	-	-
	010775	PANEL, CONTROL, SP, 364 - INDICATOR	-	-	-	1	-	-
	011189	PANEL, CONTROL, SP, 365 - INDICATOR	-	-	-	-	1	-
	009953	PANEL, CONTROL, SP, ST, SU, 366 - INDICATOR	-	-	-	-	-	1
3.1	012672	SERVICE, SMS, 10-24 X 1/2, PH, PAN, TYPE F, SS, PKG 4	2	2	2	2	2	1
3.2	012752	RECEPTACLE, BALL STUD, 18LB PULL, PKG 4	1	1	1	1	1	1
3.3	012751	POP RIVET, CSINK, 1/8DIA X .275L, SS, PKG 8	1	1	1	1	1	1
4	001410	CHIN, CONTROL PANEL, W/O HANDLE, 12" WA.	1	-	-	-	-	-
	001408	CHIN, CONTROL PANEL, W/O HANDLE, 18" WA.	-	1	-	-	-	-
	001582	CHIN, CONTROL PANEL, W/O HANDLE, 24" WA.	-	-	1	-	-	-
	001194	CHIN, CONTROL PANEL, W/O HANDLE, 36" WA.	-	-	-	1	1	1
4.1	012687	BALL STUD, MALE, 6-32UNC, .052-.078 PNT THK, P116-447-8-3B, PKG 4	1	1	1	1	1	1
4.2	012688	SERVICE, NUT, KEPS, 6-32, SS, PKG 4	1	1	1	1	1	1
5	011177	MANIFOLD, SP, 12-2, WA	1	-	-	-	-	-
	011175	MANIFOLD, SP, 18-2, WA	-	1	-	-	-	-
	011172	MANIFOLD, SPR, 24-4, WA	-	-	1	-	-	-
	010249	MANIFOLD, SP, ST, SU, 36-4, WA	-	-	-	1	-	-
	011170	MANIFOLD, SP, 36-5, WA	-	-	-	-	1	-
	009946	MANIFOLD, SP, ST, SU, 36-6, WA	-	-	-	-	-	1

Item No.	Part No.	DESCRIPTION	HSP122	HSP182	HSP244	HSP364	HSP365	HSP366
			QTY	QTY	QTY	QTY	QTY	QTY
5.1	012679	SERVICE, WSH, FLAT, 3/8 SAE, PKG 4	1	1	1	1	1	1
5.2	012681	SERVICE, NUT, 3/8-16 X .25 HT, ZN, PKG 4	1	1	1	1	1	1
6	015662	KIT, VALVE, ON-OFF, FLANGE-MOUNT, A23-F	2	2	4	4	5	6
6.1	004643	FLANGED NIPPLE, 1/4 NPT	2	2	4	4	5	6
6.2	012750	SHCS, 10-24 X .500, SS, PKG 6	1	1	2	2	2	2
6.3	014103	SERVICE, O-RING, FLANGED NIPPLE, PKG 6	1	1	1	1	1	1
7	000859	VALVE, PILOT, 1/8NPT, X 3/16 COMP., STRAIGHT	2	2	4	4	5	6
8	002321	ELBOW, ADAPTER, 1/4 NPT FEMALE X 3/8 CC	2	2	4	4	5	6
9	001413	BRACKET, VALVE ANTI-ROTATION, STD.	2	2	4	4	5	6
10	012689	SERVICE, SMS, #10 X .5, PH, PAN, ZN, PKG 3	1	1	2	2	2	2
11	005682	HOSE, FLEX, 3/8 OD, 12" F-F, NUT/FERRULE	2	2	4	4	5	6
12	001290	GRATE, SEALED BURNER, COMBO, 12" ASSY.	1	-	2	-	2	3
13	004332	GRATE, SEALED BURNER, COMBO, 5 BURNER, ASSY.	-	-	-	-	1	-
14	004333	GRATE, SEALED BURNER, COMBO, 18" ASSY.	-	1	-	2	-	-
15	002039	ORIFICE, #42, MAIN, SEALED BURNER, SF-NG	2	2	4	4	5	6
	004925	ORIFICE, #54, MAIN, SEALED BURNER, SF-LP	2	2	4	4	5	6
16	004163	REGULATOR, STRAIGHT-THRU, 1"NPT, NG	1	1	1	1	1	1
	004162	REGULATOR, STRAIGHT-THRU, 1"NPT, LP	1	1	1	1	1	1
	004165	REGULATOR, STRAIGHT-THRU, 1-1/4"NPT, NG	1	1	1	1	1	1
	004164	REGULATOR, STRAIGHT-THRU, 1-1/4"NPT, LP	1	1	1	1	1	1
17	010662	ELBOW, SINGLE FLOW, FRONT, ASSY	1	1	2	2	3	3
18	002057	BURNER BASE, SEALED BURNER SF	1	1	2	2	3	3
19	002055	HEAD, BURNER, SEALED BURNER, SF	1	1	2	2	3	3
20	002058	BURNER RING, SEALED BURNER, SF	1	1	2	2	3	3
21	014390	SERVICE, SCREW, MOUNTING, M5X12, PKG 4	1	1	1	1	1	1
22	002056	GASKET, MAIN, SEALED BURNER, SF	1	1	2	2	3	3
23	002048	JET HOLDER, MAIN, SEALED BURNER, SF/DF	1	1	2	2	3	3
24	009106	PILOT, SEALED BURNER, ASSY	2	2	4	4	5	6
24.1	008771	PILOT, SEALED BURNER	1	1	1	1	1	1
24.2	014391	SERVICE, NUT, LOCK, PILOT, SEALED BURNER, PKG 3	1	1	1	1	1	1
24.3	014392	SERVICE, WASHER, BRASS, .500IDX.750 OD X .025 THK, PKG 3	1	1	1	1	1	1
24.4	014396	SERVICE, ADAPTER, PILOT, SEALED BURNER, KIT	1	1	1	1	1	1
25	005688	HOSE, FLEX, 3/16 OD, 18", F-F, NUT/FERRULE	1	1	2	2	3	3
26	002034	ELBOW, SINGLE BURNER, ASSY.	1	1	2	2	3	3
27	002057	BURNER BASE, SEALED BURNER SF	1	1	2	2	3	3
28	002055	HEAD BURNER, SEALED BURNER, SF	1	1	2	2	3	3
29	002058	BURNER RING, SEALED BURNER, SF	1	1	2	2	3	3
30	014390	SERVICE, SCREW, MOUNTING, M5X12, PKG 4	1	1	1	1	1	1
31	002056	GASKET, MAIN, SEALED BURNER, SF	1	1	2	2	3	3

Item No.	Part No.	DESCRIPTION	HSP122	HSP182	HSP244	HSP364	HSP365	HSP366
			QTY	QTY	QTY	QTY	QTY	QTY
32	002048	JET HOLDER, MAIN, SEALED BURNER, SF/DF	1	1	2	2	3	3
33	011180	HOSE, FLEX, 3/16 OD, 30", BLANK-F, NUT/FERRULE	1	1	2	2	3	3
33.1	004827	FERRULE, 3/16 COMP.	1	1	2	2	3	3
33.2	004824	NUT, 3/16 COMP.	1	1	2	2	3	3
34	010263	BOWL, SEALED BURNER, 12", SF, WA	1	-	-	-	-	-
	010262	BOWL, SEALED BURNER, 18", SF, WA	-	1	-	-	-	-
	010261	BOWL, SEALED BURNER, 24", SF, WA	-	-	1	-	-	-
	009440	BOWL, SEALED BURNER, 36"-4, SF, WA	-	-	-	1	-	-
	010260	BOWL, SEALED BURNER, 36"-5, SF, WA	-	-	-	-	1	-
	009438	BOWL, SEALED BURNER, 36"-6, SF, WA	-	-	-	-	-	1
	010270	BOWL, SEALED BURNER, 12", SF, WA, LP	1	-	-	-	-	-
	010268	BOWL, SEALED BURNER, 18", SF, WA, LP	-	1	-	-	-	-
	010267	BOWL, SEALED BURNER, 24", SF, WA, LP	-	-	1	-	-	-
	010266	BOWL, SEALED BURNER, 36"-4, SF, WA, LP	-	-	-	1	-	-
	010265	BOWL, SEALED BURNER, 36"-5, SF, WA, LP	-	-	-	-	1	-
010264	BOWL, SEALED BURNER, 36"-6, SF, WA, LP	-	-	-	-	-	1	
34.1	014376	SERVICE, SCREW COVER, SEALED BURNER, WA, PKG 6	1	1	1	1	1	1
35	001047	DRAIN, 1 1/2", SEALED BURNER, ASSY.	-	1	1	1	1	1
	004747	DRAIN, 1 1/2", SEALED BURNER, 12" ASSY.	1	-	-	-	-	-
35.1	001041	WASHER, DRAIN, SEALED BURNER	1	1	1	1	1	1
35.2	001037	PLUG, DRAIN, SEALED BURNER	1	1	1	1	1	1
35.3	001262	PLUG, DRAIN, OVERFLOW, SEALED BURNER	1	1	1	1	1	1
	001291	O-RING, SIZE 214, SILICONE, OVERFLOW DRAIN PLUG	1	1	1	1	1	1
	001329	STRAINER, CUSTOM, DRAIN, SEALED BURNER	1	1	1	1	1	1
36	000254	UNION, 1.25" NPT - 5P594	1	1	1	1	1	1
37	000258	PLUG, SQUARE SOCKET, 1" NPT	1	1	1	1	1	1
38	AHRGC	REAR GAS CONNECTION, 1" NPT	1	1	1	1	1	1
39	AHCCR	CAP, MANIFOLD, RIGHT, ASSY	1	1	1	1	1	1
40	AHCCL	CAP, MANIFOLD, LEFT, ASSY	1	1	1	1	1	1
41	000470	ADJUSTABLE LEG, ASSY, 4"	4	4	4	4	4	4
42	000122	PANEL, SIDE, RH, RANGETOP	1	1	1	1	1	1
43	000501	PANEL, SIDE, LH, RANGETOP	1	1	1	1	1	1
44	013303	SERVICE, HB, 1/4-20 X .5, ZN, PKG 8	1	1	1	1	1	1
45	000360	PLUG, HEX SOCKET, 1/8" NPT	1	1	1	1	1	1
46	014191	SERVICE, HB, 1/4-20 X .625, SS, PKG 4	4	4	4	4	4	4